

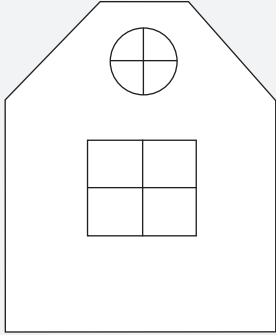

Barn Parts Included

Please check that all the following parts have been included in the package.



2 - Sides of Barn

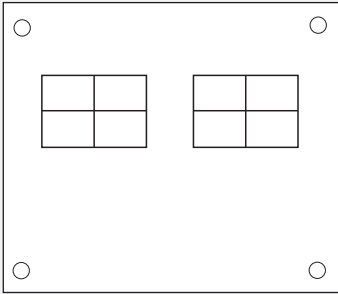

1 - Back of Barn

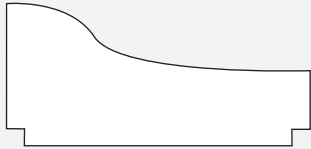

1 - Stall Divider

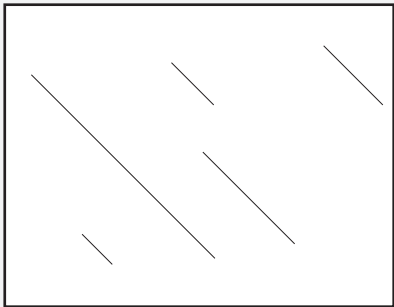

2 - Floors

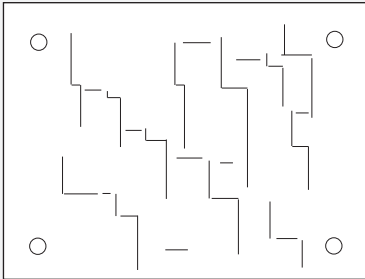

1 - Barn Roof

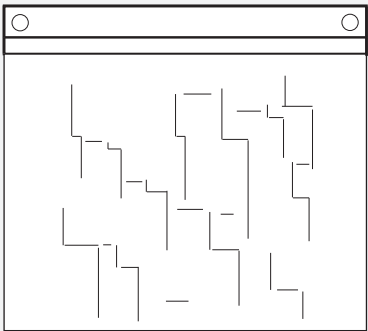

1 - Barn Roof (hinged)

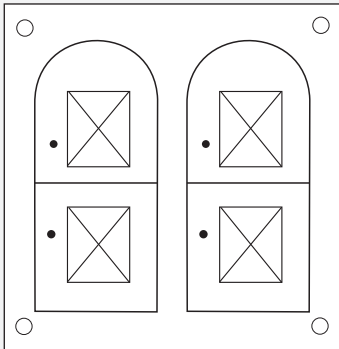

1 - Front of Barn

4 - Short Connecting Screws

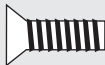

4 - Long Connecting Screws



1 - Hex Key

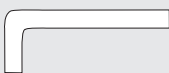



Two Stall Barn Assembly Directions

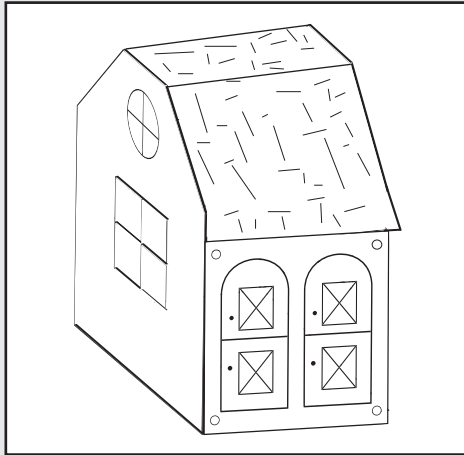

- Thank you for purchasing a Paradise Horses' wooden accessory product.
- Please read these instructions before assembling the barn.
- Keep this instruction sheet for future reference.
- Adult assembly required.

CAUTION

This package contains small parts in its unassembled state. Adult assembly is required.

1

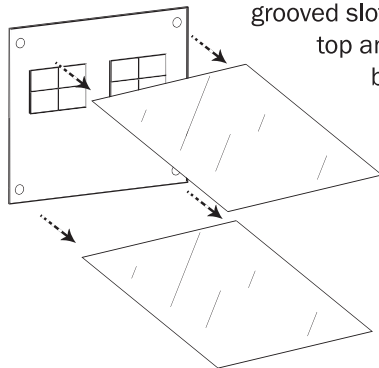

- Insert barn floors into the grooved slots located at the top and bottom of the back of the barn.

2

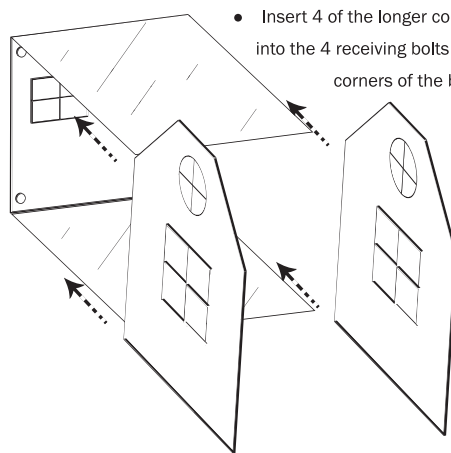

- Slide the sides of the barn onto the two floors
- Insert 4 of the longer connecting screws into the 4 receiving bolts located in the 4 corners of the back of the barn.
- Tighten the connecting screws using the hex key.

3

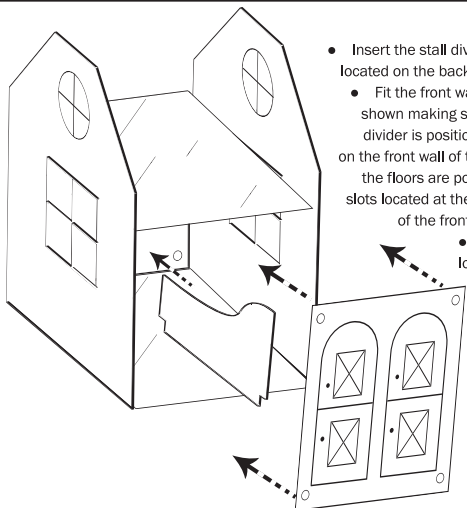

- Insert the stall divider into the slot located on the back wall of the barn.
- Fit the front wall of the barn as shown making sure that the stall divider is positioned into the slot on the front wall of the barn and that the floors are positioned into the slots located at the top and bottom of the front wall of the barn.
- Insert 4 of the longer connecting screws into the 4 receiving bolts located on the front wall of the barn and tighten the connecting screws with the hex key.

4

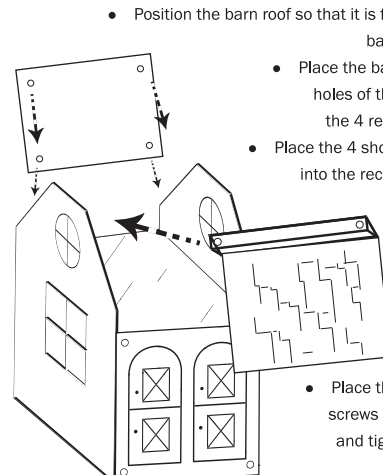

- Position the barn roof so that it is flat against the slanted back top side of the barn.
- Place the barn roof such that the 4 holes of the roof are aligned with the 4 receiving bolts at the top.
- Place the 4 shorter connecting screws into the receiving bolts and tighten with the hex key.
- Place the barn roof (hinged) on top of the barn such that the 2 holes are aligned with the 2 receiving bolts.
- Place the 2 longer connecting screws into the receiving bolts and tighten using the hex key.